

The Station

Plans drawn and Designed By Jeffrey Howe ©



All measurements in these plans are from our own build, you should always check your own model before cutting anything.



S1 Mould



S2 Mould



S4 Mould



S3 Mould



S5 Mould



NS/01-02 stone



Victorian roof
Mould CM 021

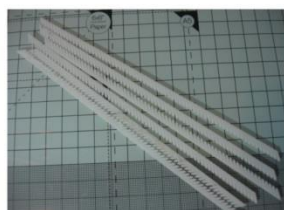

6 Barge boards



6 Chimney Pots

Construct the rear (Platform side) wall in three parts.

Using the parts below

Build the sections..

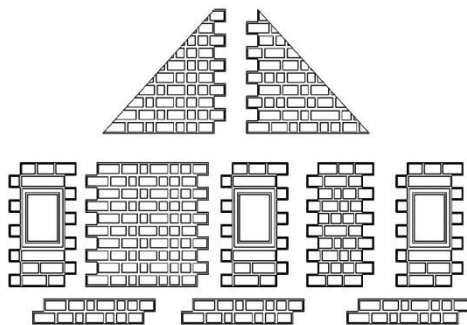

Section 1

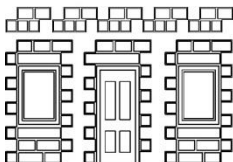
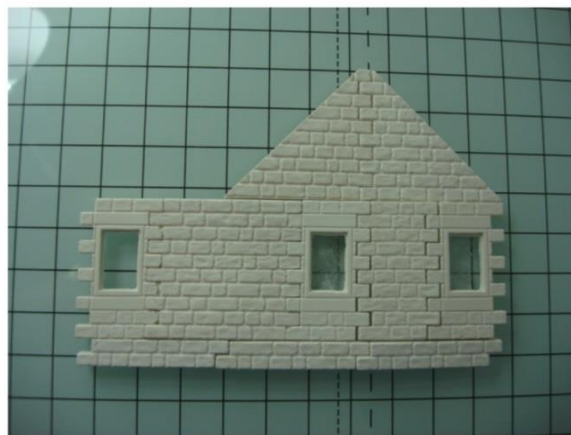
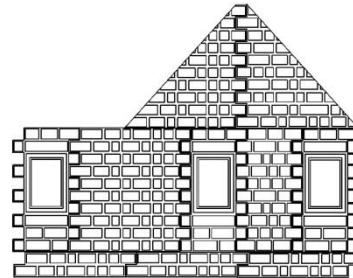

Section 2

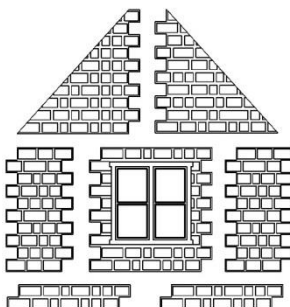
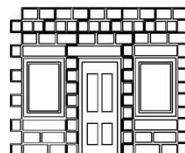

Section 3

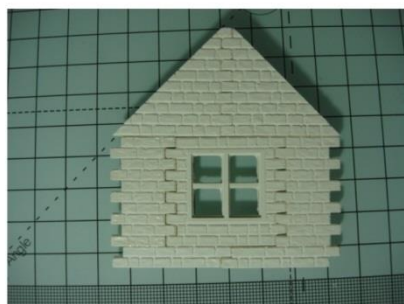
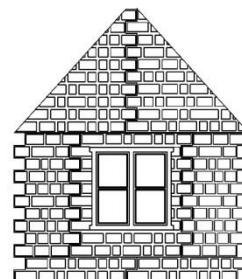

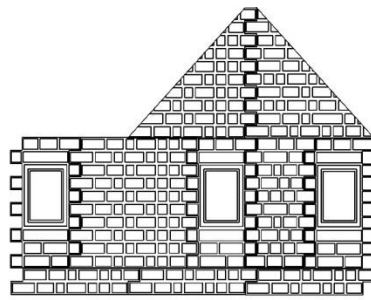

Section 1

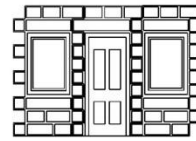

Section 2

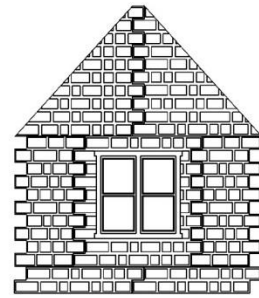

Section 3



Take 3 of these casts

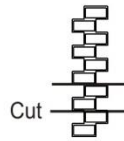

From one, cut 2 rows off twice



Glue 1 piece to the bottom of each of the other 2



to produce these pieces.

Glue these 2 pieces at right angles to the front two pieces as shown

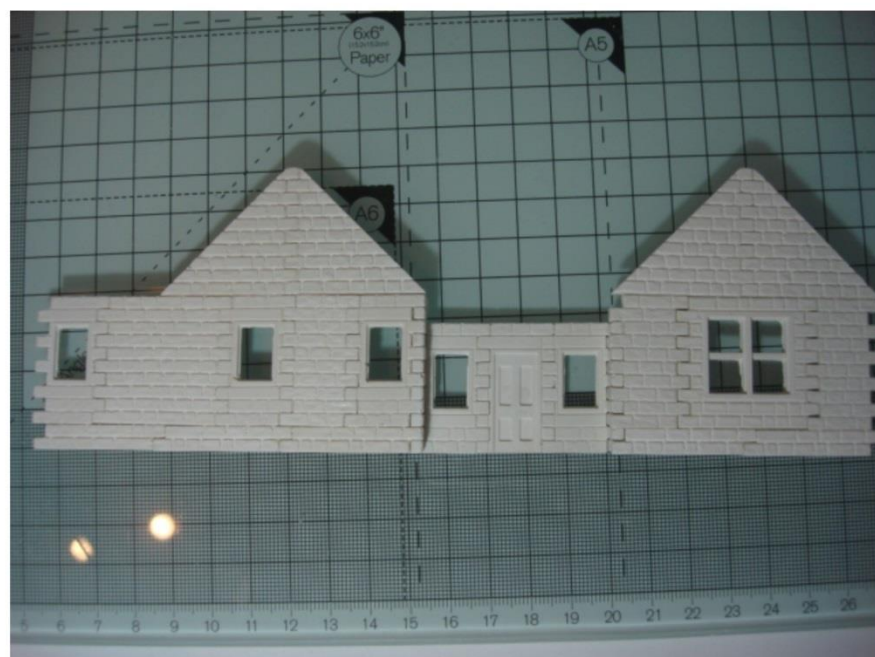
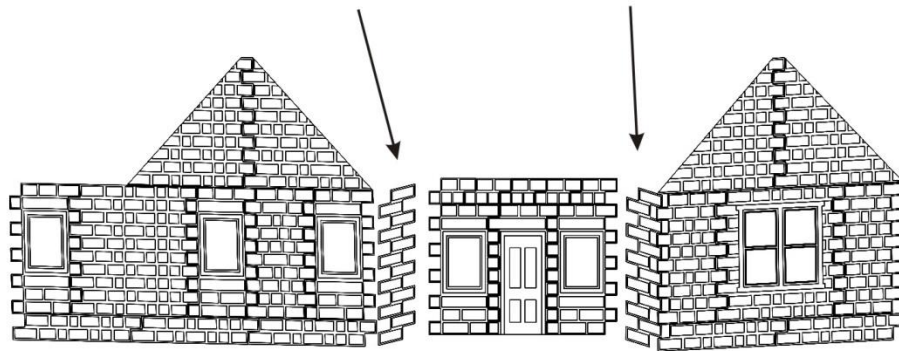

Front Wall (Road Side) construction.

Take these casts to make the sections.....

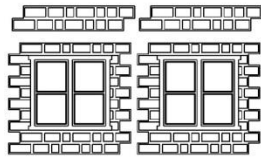

Section 1

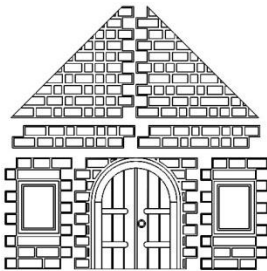
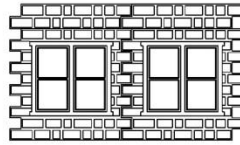

Section 2

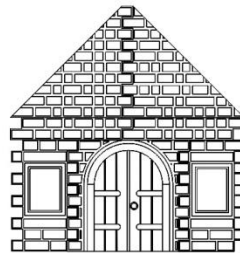

For section 3 take 1 cast S3-128 and cut as shown

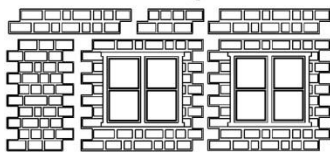
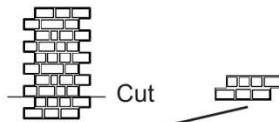

Section 3

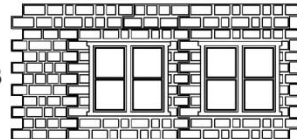

Using 2 cast S1-38 and 2 cast S7-000 make 2 walls.

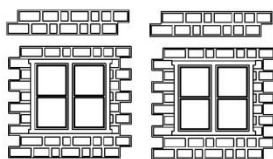

Section 4

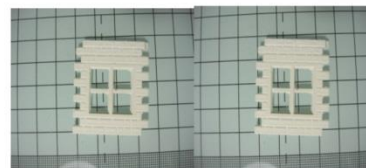
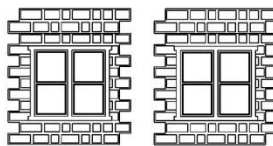

Put all pieces aside to dry before moving on.

When dry, using the two pieces of section 4, glue one to each side of section 2, at right angles ensuring the corners are square.

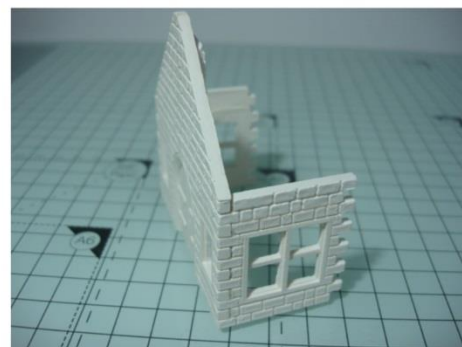
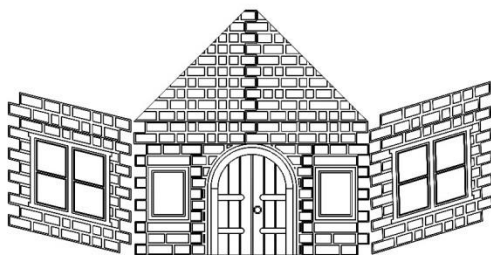

Designed by Jeff Howe

November 2014

When dry glue this piece to sections 1 and 3 as shown.

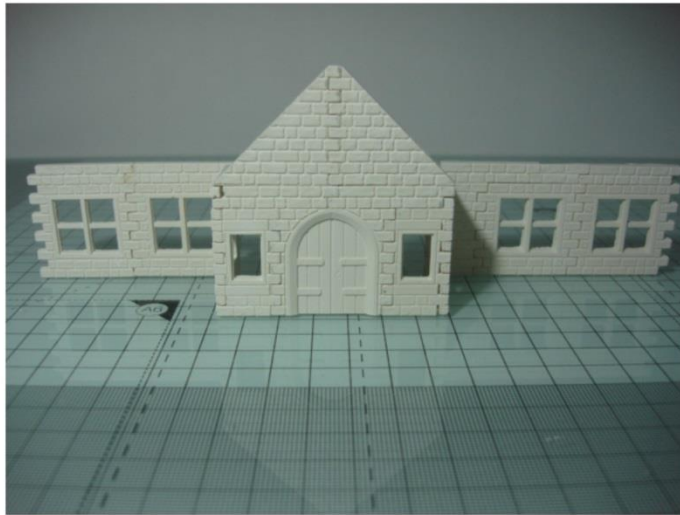
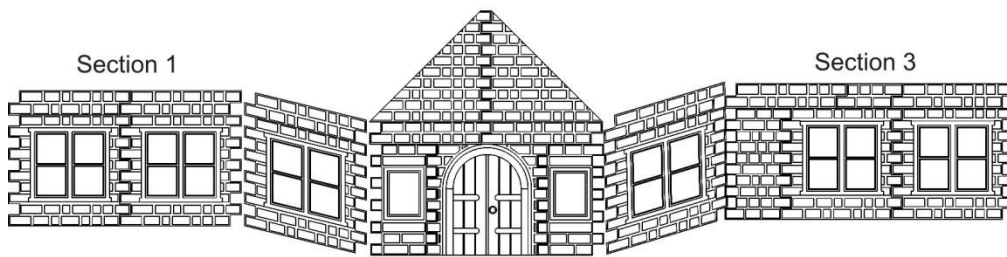

Use the casts below.....to make the right hand wall



Using the cast below.....Make the left end wall.

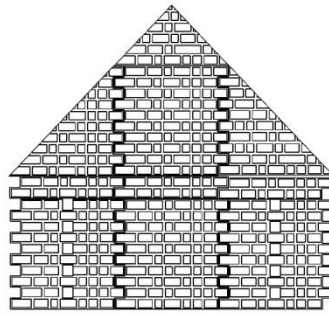
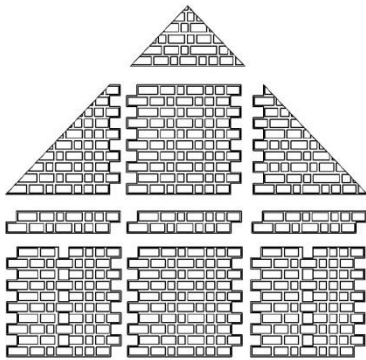

Now that all the walls are made we can begin assembly of the building.

Take the rear (platform side) wall and glue to the left hand wall.

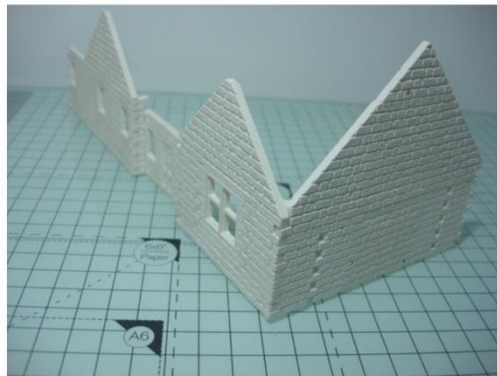

Now take the front wall assembly, and glue to the right hand wall.



When the two sub assemblies are dry, carefully glue them together, to make the complete building.



Parts for the back wall (Platform side) of the extension.

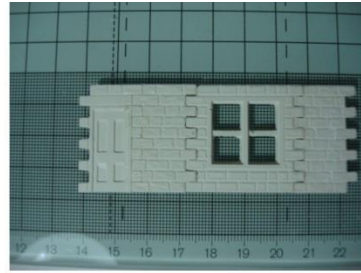
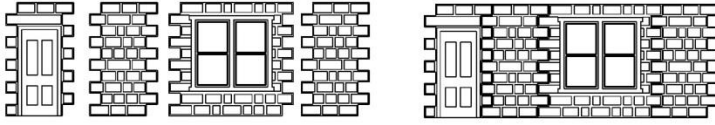

Parts for the front wall (Road side) of the extension.

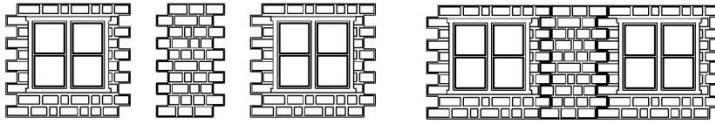

Parts for the end wall of the extension.

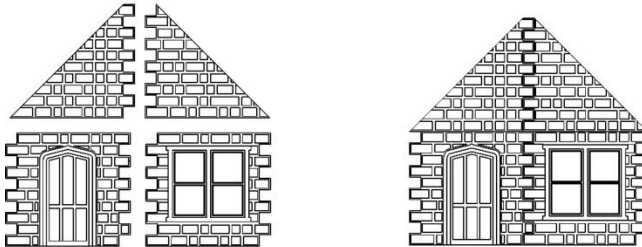

When these pieces are dry, glue them all to the left hand end wall at the same time with 2 cast S4-36 in the corners to add strength and help make square corners.

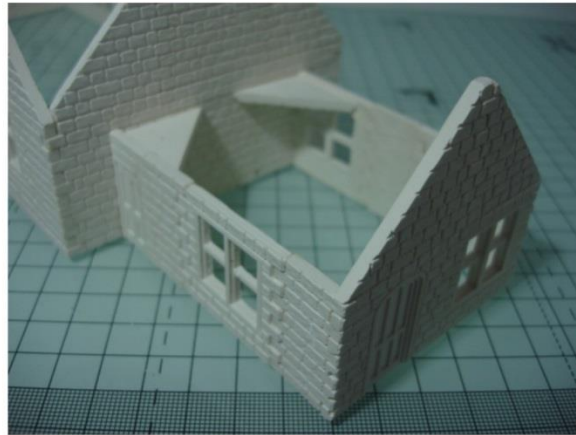

Then add cast S4-35L and S4-35R to the end wall of the main building, these will support the roof.



Roof Construction.

Take 1 full roof sheet cast and cut as per the diagram.

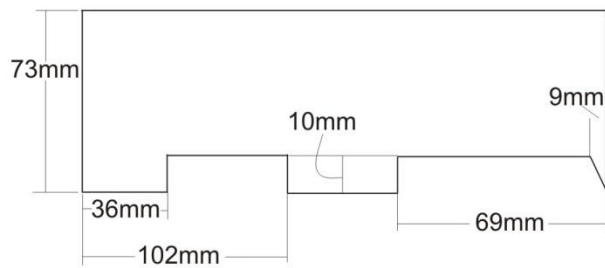

Glue this to the platform side of the building.



Take a full roof sheet cast and cut as per the diagram.

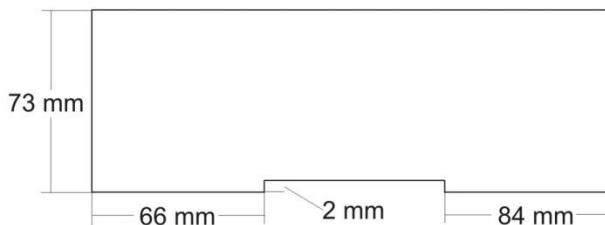

Glue this to the road side of the building.



From the Third roof sheet cut 2 pieces as per the diagram. Try and match the roof tile pattern to the main building as this will make the finished roof look better.

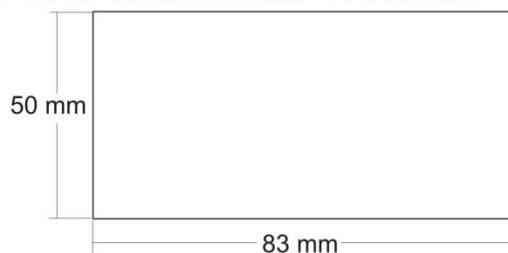

Glue these to the extension building.



Dormer Roof construction.

From stiff card, cut out a template as per the diagram, this will be used to cut two left hand and two right hand roof pieces for the rear dormers.

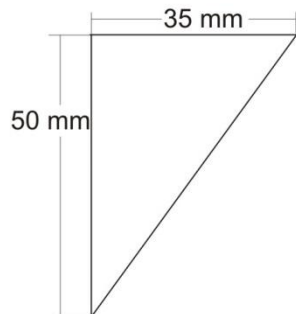

Now from a roof sheet cut two left hand and two right hand pieces.

BE CAREFUL to line up the pattern of the roof tiles with the main building before cutting these pieces, so that when they are glued in place the lines or the tiles are continuous, this will make the finished model look better.

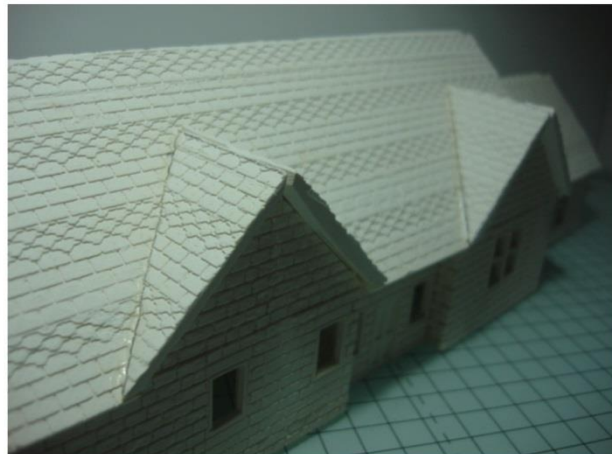
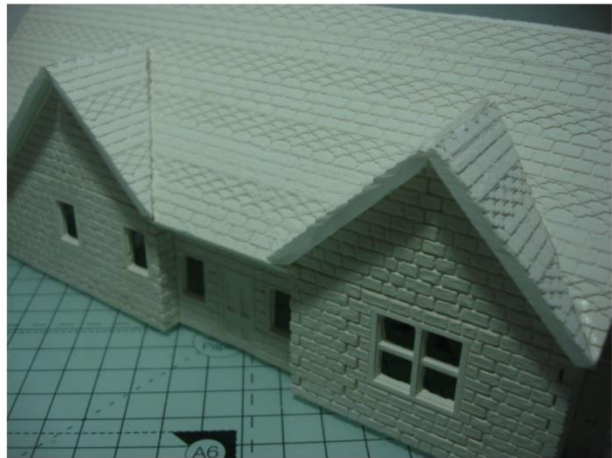

From stiff card again cut a template as per the diagram.

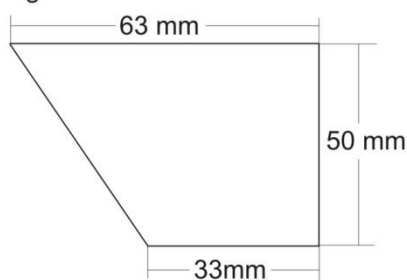

Now from the roof sheet cut 1 left hand and 1 right hand piece.

Again make sure you line up the roof tile patterns on the main roof with the 2 cut pieces.

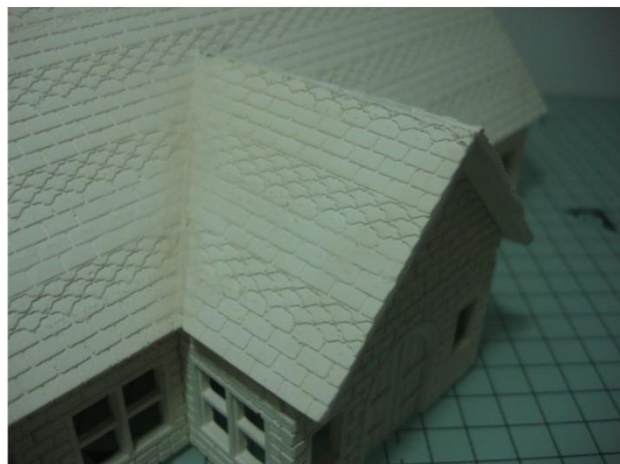

To make fitting the ridge tiles easier, use cast S2-152 several pieces need to be glued in the top ridge of both roofs.

Then take three casts S5-46 and glue together, this needs to be done three times to produce the chimney stacks.

Glueing three together gives the stacks a more substantial look.



When dry they can be glued in place on the ridge of the roof in the positions of your choice.



Now using the ridge tile pieces, cut and glue to the tops of all roofs including the dormers.

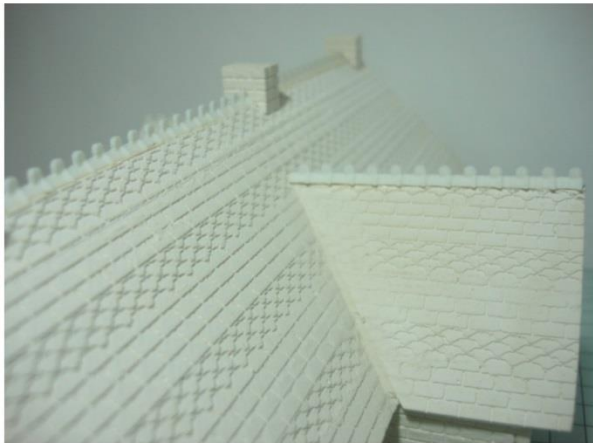

Using the Barge boards carefully cut to length and glue to all dormer ends.

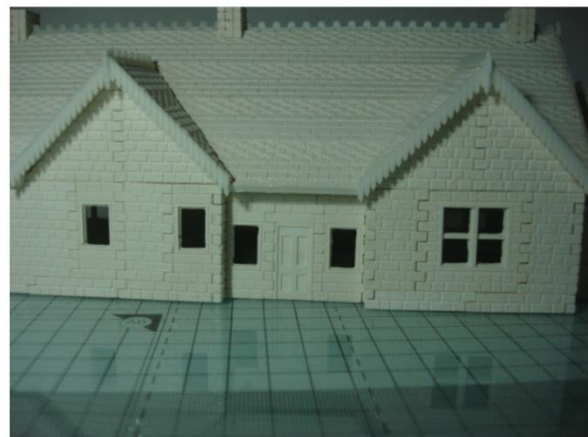

Now take the six chimney pots and glue two on each chimney stack.

Finally add any other items you like, I have used a cocktail stick fixed in the roof of the extension as a smoke stack for a wood burner in the platform workers mess room, you can also add gutters and down-pipes etc.



All that remains is to paint the model in your colour scheme.



Plans by Jeff Howe

We hope you enjoyed making the model and of course you can put all your own finishing touches to complete your model. The best thing is that you can change the design to suit yourself and put your own imagination into whatever you build.

There are many more building plans on the website www.linkaonline.co.uk and we are introducing many new products to give you even more different elements to create your very own models, Scenes and a host of products to add those finishing touches.

Also remember that you can add to your moulds collection to give you even more scope in your creations.

Finally there are many step by step guides, painting articles, videos on casting as well as the online forums to help you with anything you need and you are always welcome to contact us on the website if you need anything at all.

Note:-

This product is the property of Linkonline and may be used for personal use only, copying, selling and/or sharing this product publically infringes our copyrights. Please help us to keep bringing you, new content, products and plans by not distributing this product.